

# Broken Hill Annexe

## Location Guide

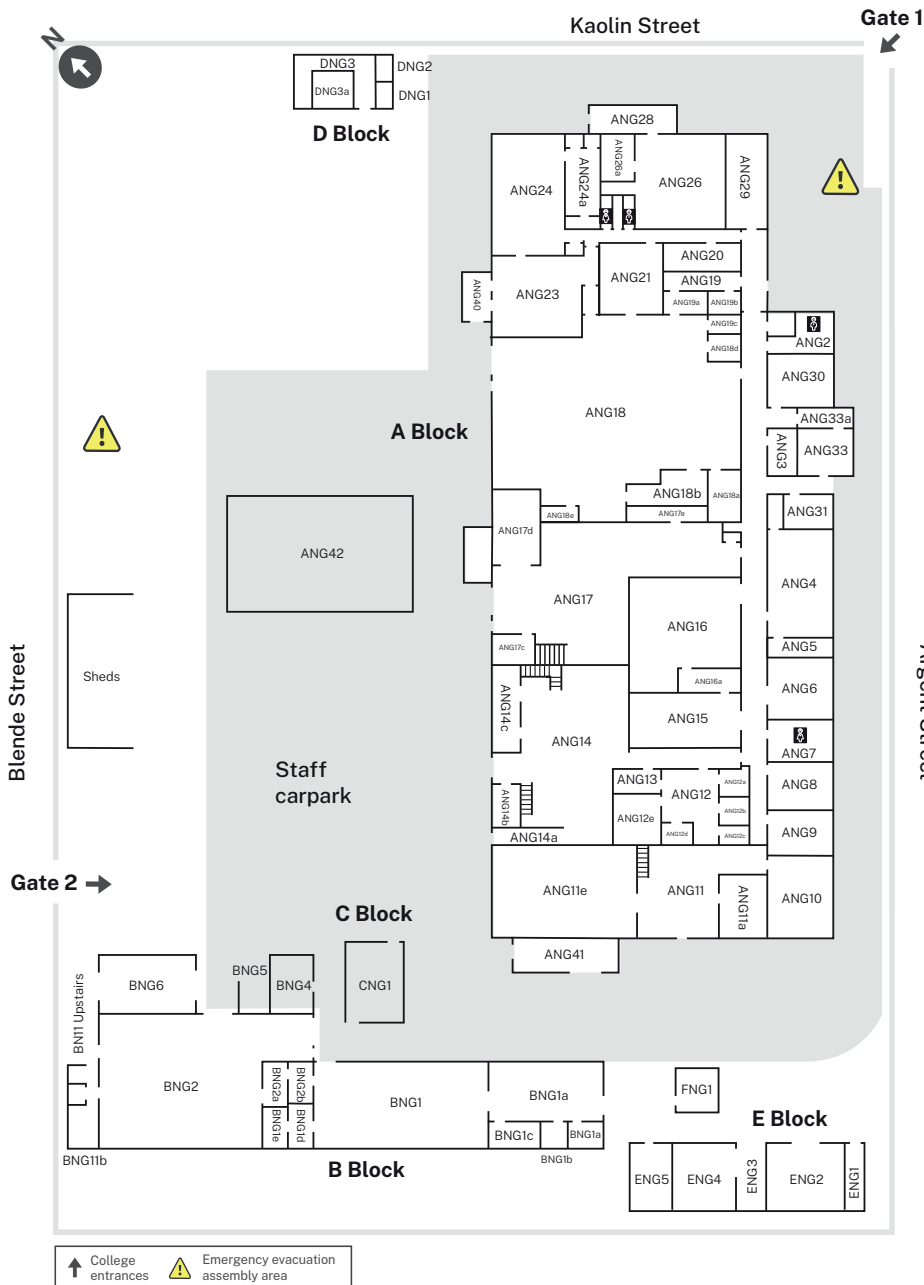

### A- Block

- Toilets & Shower -Male ANG2
- Office-TSM & TSC ANG3
- Classroom-Electrical ANG4
- Office-Electrical Staff ANG5
- Toilets & Shower -Female ANG7
- Connected Learning Point ANG8
- Art Room -Fine Arts ANG11e
- Carpentry ANG12
- Office-Carpentry Staff ANG13
- Workshop -Carpentry ANG14
- Electrical Laboratory ANG15
- Workshop -Electrical ANG16
- Workshop -Automotive ANG17
- Office -Automotive Staff ANG17c
- Workshop -Fitting & Machining ANG18
- Office -Art & Civil Construction Staff ANG19
- Office-Fitting & Machining Staff ANG19a
- Office-Hospitality Staff ANG20
- Connected Learning Point ANG21
- Restaurant ANG23
- Kitchen ANG24
- Workshop -Pottery ANG26
- Pottery Kilns ANG28
- Students Common Room ANG30
- Office-Facilities Coordinator and Facilities Officers ANG33
- COLA-Carpentry ANG42

### B- Block

- Welding BNG1
- Metal Fabrication BNG2
- Toilets BNG4
- Metal Fabrication-Welding Bays BNG5
- Office-Metal Fabrication Offices BN11

Published in June 2022

60 Argent St,  
Broken Hill  
NSW 2380

Bus 593 alights  
near Gate 2 on Blende St

TAFE NSW Broken Hill (Annexe) is around  
12 mins walk from the train station.  
For timetable information, please call  
131 500 or visit [transportnsw.info](http://transportnsw.info)

[tafensw.edu.au](http://tafensw.edu.au)  
131 601



**TAFE**NSW